

POWER Inspired

iPower-H DC UPS Quick Guide

V1.0

1. Package Contents

You should have received the following items inside of package:

- iPower DC UPS adapter unit
- Quick Guide

A DC adapter jack set may also be provided as an optional accessory.

2. Product Overview

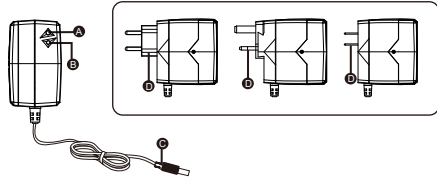

- A On/Off Button
- B LED indicator
- C DC output connector
- D AC input

Power Inspired Ltd, Unit 122, Churchhill Road, Bicester, OX26 4XD, UK
www.powerinspired.com



3. Installation and Operation

NOTE: Before installation, please inspect the unit. Be sure that nothing inside the package is damaged. If a battery insulator tab is fitted, remove this first.

Connect to Utility and Charging

Plug in the AC input plug **A** to the wall outlet. The UPS will be automatically turned on and green LED will light on. If battery is not fully charged, the UPS will auto charge the battery and the green LED will flash.

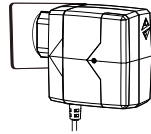

Connect the Loads

Plug the DC output connector **C** of the iPower into the load. The connected device is now protected by the iPower.

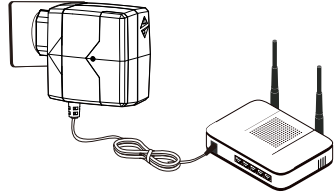

On/Off Button Operation

The iPower will automatically turn on when plugging into wall outlet under normal utility condition. If the iPower is in fault mode, pressing button **A** for over 1 sec will reset it. If the iPower is operating in battery mode, to avoid battery drain, press and hold for 5 seconds to shut down. If the utility is not available and battery is fully charged, you may simply press this button for 5 seconds to turn on the iPower.

LED Indication

The LED is a two-colour indicator: green or red depending on operation status.

Status	Colour	On/Flash
Power on with battery fully charged.	Green	On
Power on with charging battery.	Green	Steady Flash
iPower on battery and discharging.	Green	Quick Flash
A fault on the iPower.	Red	On
UPS has detected that the battery is not connected, while the utility power is available.	Red	Steady Flash

4. Applications

The iPower is designed to provide emergency power backup to all kinds of DC powered equipment such as routers, modems, set-top box, VOIP phone systems, surveillance system, alarm system, access control system and many critical telecoms equipment.

5. Important Safety Warning (SAVE THESE INSTRUCTIONS)

To safely operate this unit, please read and follow all instructions carefully. Read this manual thoroughly before attempting to unpack, install, or operate. You should keep this quick guide for further reference.

CAUTION! Do NOT place this unit in a hot and humid environment.

CAUTION! Do NOT disassemble this product.

CAUTION! If the battery level is low, please recharge the battery immediately.

NOTE! Warranty is voided if battery compartment is opened.

LED Indication

The LED is a two-colour indicator: green or red depending on operation status.

Status	Colour	On/Flash
Power on with battery fully charged.	Green	On
Power on with charging battery.	Green	Steady Flash
iPower on battery and discharging.	Green	Quick Flash
A fault on the iPower.	Red	On
UPS has detected that the battery is not connected, while the utility power is available.	Red	Steady Flash

4. Applications

The iPower is designed to provide emergency power backup to all kinds of DC-powered equipment such as routers, modems, set-top box, VOIP phone systems, surveillance system, alarm system, access control system and many critical telecoms equipment.

5. Important Safety Warning (SAVE THESE INSTRUCTIONS)

To safely operate this unit, please read and follow all instructions carefully. Read this manual thoroughly before attempting to unpack, install, or operate. You should keep this quick guide for further reference.

CAUTION! Do NOT place this unit in a hot and humid environment.

CAUTION! Do NOT disassemble this product.

CAUTION! If the battery level is low, please recharge the battery immediately.

NOTE! Warranty is voided if battery compartment is opened.

6. Troubleshooting

Problem	Possible Cause	Solutions
Red LED is ON	Battery insulator tab Overload or short circuit occurred and iPower transferred to fault mode.	Remove Battery insulator tab Remove excess load. Press button A for more than 1 second and release to restart unit.
Battery backup time is shorter than nominal value.	Battery near end of life	Contact your dealer.
No output and LED indicator is not on.	Internal fault has occurred.	Contact your dealer.
Red LED is flashing.	UPS has detected that battery is not connected or battery voltage is too low or battery is defective.	Remove the Battery insulator tab from battery if it is not removed. If red LED flashes even after Battery insulator tab is removed, contact dealer to replace the battery.

7. Specifications

AC INPUT	
Voltage Range	90VAC ~ 264VAC
Frequency	50 or 60Hz
DC OUTPUT	
Voltage	12Vdc ± 5%
Max Power	25W (2.1A)
Continuous Power	12W (1A)
BATTERY	
Type	Lithium-ion
Nominal Voltage	3.6VDC
Capacity	3350mAh
Typical Charging Time	3.6 hours to 90% Capacity
PHYSICAL	
Input Plug	Mounted on housing (NEMA / Schuko/UK)
Output Cable	2m – DC Male Jack (OD 5.5mm ID 2.1mm)
Dimension DxWxH (mm)	68x42x74
Net Weight	280g
Surge Protection	K.21 Enhanced 6KV

POWER Inspired

iPower-H DC UPS Quick Guide

V1.0

1. Package Contents

You should have received the following items inside of package:

- iPower DC UPS adapter unit
- Quick Guide

A DC adapter jack set may also be provided as an optional accessory.

2. Product Overview

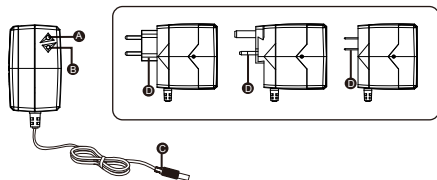

- A On/Off Button
- B LED indicator
- C DC output connector
- D AC input

Power Inspired Ltd, Unit 122, Churchhill Road, Bicester, OX26 4XD, UK
www.powerinspired.com



3. Installation and Operation

NOTE: Before installation, please inspect the unit. Be sure that nothing inside the package is damaged. If a battery insulator tab is fitted, remove this first.

Connect to Utility and Charging

Plug in the AC input plug **A** to the wall outlet. The UPS will be automatically turned on and green LED will light on. If battery is not fully charged, the UPS will auto charge the battery and the green LED will flash.

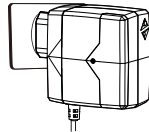

Connect the Loads

Plug the DC output connector **C** of the iPower into the load. The connected device is now protected by the iPower.

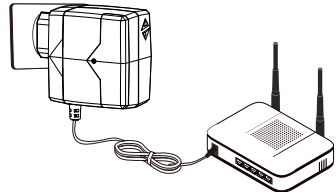

On/Off Button Operation

The iPower will automatically turn on when plugging into wall outlet under normal utility condition. If the iPower is in fault mode, pressing button **A** for over 1 sec will reset it. If the iPower is operating in battery mode, to avoid battery drain, press and hold for 5 seconds to shut down. If the utility is not available and battery is fully charged, you may simply press this button for 5 seconds to turn on the iPower.

6. Troubleshooting

Problem	Possible Cause	Solutions
Red LED is ON	Battery insulator tab Overload or short circuit occurred and iPower transferred to fault mode.	Remove Battery insulator tab Remove excess load. Press button A for more than 1 second and release to restart unit.
Battery backup time is shorter than nominal value.	Battery near end of life	Contact your dealer.
No output and LED indicator is not on.	Internal fault has occurred.	Contact your dealer.
Red LED is flashing.	UPS has detected that battery is not connected or battery voltage is too low or battery is defective.	Remove the Battery insulator tab from battery if it is not removed. If red LED flashes even after Battery insulator tab is removed, contact dealer to replace the battery.

7. Specifications

AC INPUT	
Voltage Range	90VAC ~ 264VAC
Frequency	50 or 60Hz
DC OUTPUT	
Voltage	12Vdc ± 5%
Max Power	25W (2.1A)
Continuous Power	12W (1A)
BATTERY	
Type	Lithium-ion
Nominal Voltage	3.6VDC
Capacity	3350mAh
Typical Charging Time	3.6 hours to 90% Capacity
PHYSICAL	
Input Plug	Mounted on housing (NEMA / Schuko/UK)
Output Cable	2m – DC Male Jack (OD 5.5mm ID 2.1mm)
Dimension DxWxH (mm)	68x42x74
Net Weight	280g
Surge Protection	K.21 Enhanced 6KV